

Nikon

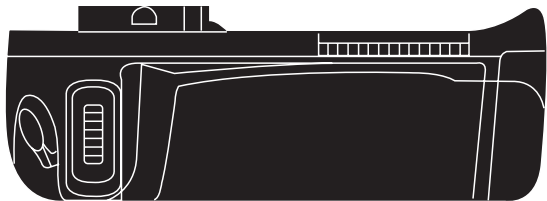

Multi-Power Battery Pack

MB-D11

.....

User's Manual

- | | |
|----|----|
| Jp | Hu |
| En | Sk |
| De | Sl |
| Fr | Et |
| Es | Lv |
| No | Lt |
| Sv | Is |
| Fi | Ro |
| Ru | Ua |
| Dk | Sc |
| Nl | Tc |
| Pt | Kr |
| It | Th |
| Gr | Id |
| Pl | Tr |
| Cz | Ar |

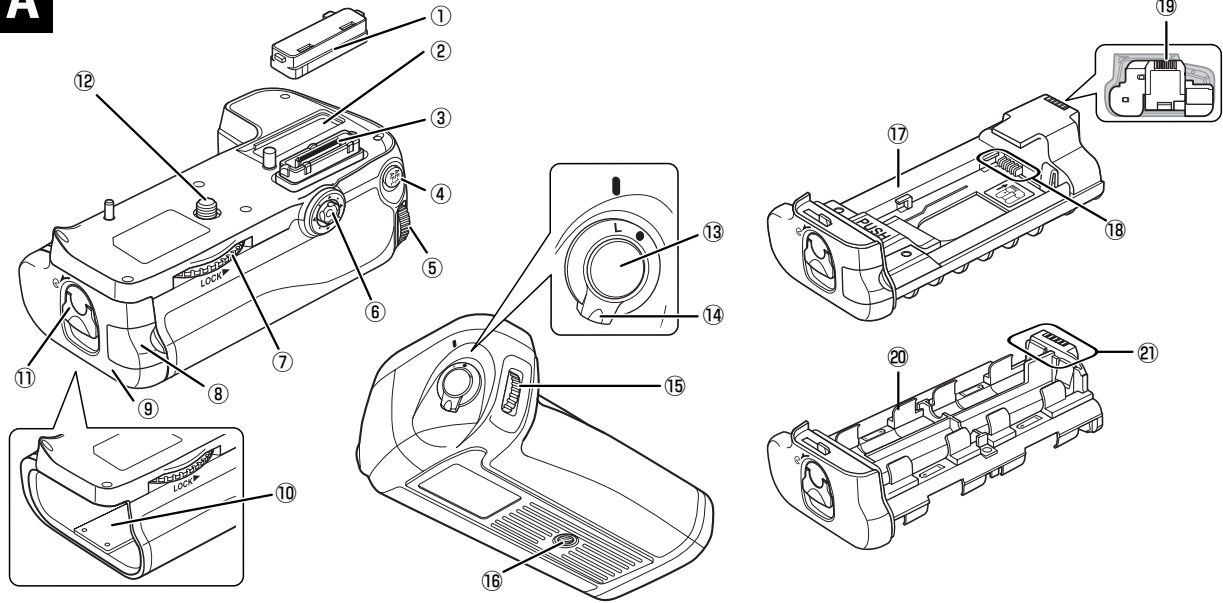
A

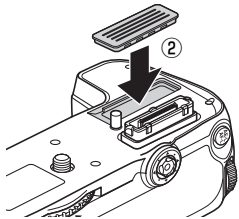
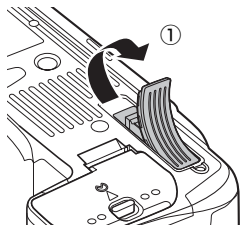
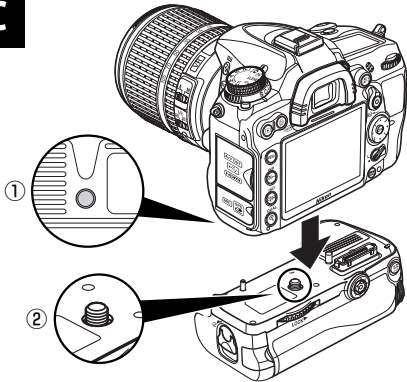
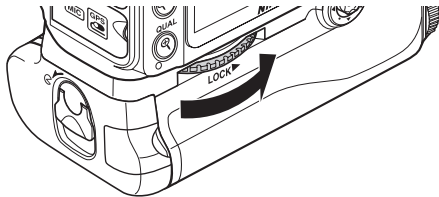
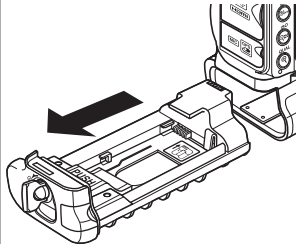
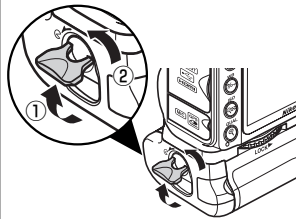
B**C****D****E**

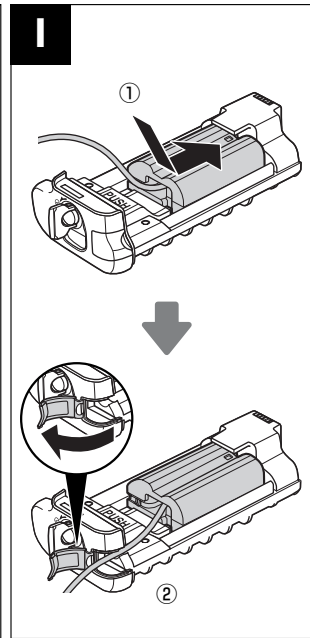
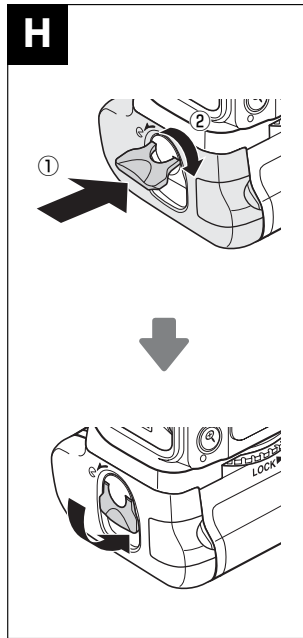
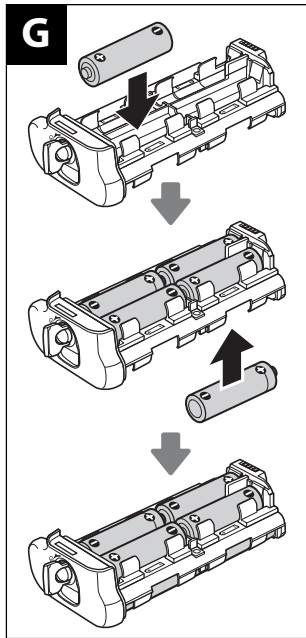
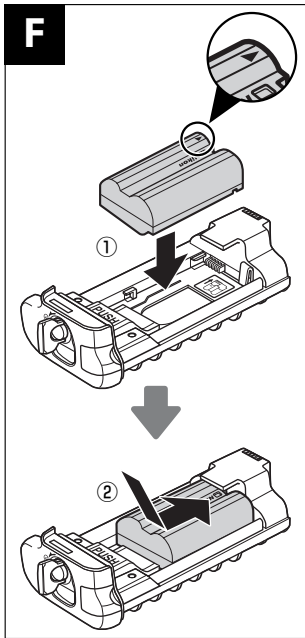

MB-D11 Multi-Power Battery Pack

User's Manual

Table of Contents

Safety Precautions	2
Notice for Customers in Europe	2
Precautions for Use	2
Introduction	4
The MB-D11 and Accessories	4
The MB-D11 and Supplied Accessories.....	4
Using the Optional EH-5a AC Adapter and EP-5B Power Connector	4
Parts of the MB-D11	5
The MB-D11 Shutter-Release Button, Multi Selector, Command Dials, and AE-L/AF-L Button.....	5
The MB-D11 Control Lock.....	5
Using the Battery Pack	6
Attaching the Battery Pack.....	6
Removing the Battery Pack	6
Inserting Batteries	7
Removing Batteries	9
Specifications.....	10

Safety Precautions

En

To ensure proper operation, read this manual thoroughly before using this product. After reading, be sure to keep it where it can be seen by all those who use the product.

Notice for Customers in Europe

CAUTION

RISK OF EXPLOSION IF BATTERY IS REPLACED BY AN INCORRECT TYPE. DISPOSE OF USED BATTERIES ACCORDING TO THE INSTRUCTIONS.

This symbol indicates that electrical and electronic equipment is to be collected separately.

The following apply only to users in European countries:

- This product is designated for separate collection at an appropriate collection point. Do not dispose of as household waste.



- Separate collection and recycling helps conserve natural resources and prevent negative consequences for human health and the environment that might result from incorrect disposal.
- For more information, contact the retailer or the local authorities in charge of waste management.

Precautions for Use

- The MB-D11 is for use with compatible cameras only.
- Do not use with batteries and battery holders not recommended in this manual.
- To prevent electrical shorts caused by metal objects touching the power terminals, replace the contact cap when the MB-D11 is not in use.
- When a battery holder is removed from the MB-D11, remove the batteries or place the holder or cover in the holder case to prevent electrical shorts caused by contact with other metal objects.
- The memory card access lamp may light up when the MB-D11 is attached or removed from the camera, but this is not malfunction.
- Should you notice smoke or an unusual smell or noise from the battery pack, discontinue use immediately. After removing the batteries, take the device to the retailer or a Nikon-authorized service representative for inspection.
- The MB-D11 is not equipped with a power switch. Use the camera power switch to turn the power on or off.

✔ **Notice for Customers in the U.S.A.**

Federal Communications Commission (FCC) Radio Frequency Interference Statement

This equipment has been tested and found to comply with the limits for a Class B digital device, pursuant to Part 15 of the FCC rules. These limits are designed to provide reasonable protection against harmful interference in a residential installation. This equipment generates, uses, and can radiate radio frequency energy and, if not installed and used in accordance with the instructions, may cause harmful interference to radio communications. However, there is no guarantee that interference will not occur in a particular installation. If this equipment does cause harmful interference to radio or television reception, which can be determined by turning the equipment off and on, the user is encouraged to try to correct the interference by one or more of the following measures:

- Reorient or relocate the receiving antenna.
- Increase the separation between the equipment and receiver.
- Connect the equipment into an outlet on a circuit different from that to which the receiver is connected.
- Consult the dealer or an experienced radio/television technician for help.

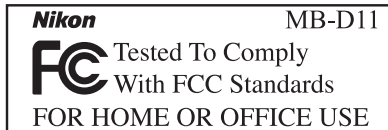

CAUTION

Modifications: The FCC requires the user to be notified that any changes or modifications made to this device that are not expressly approved by Nikon Corporation may void the user's authority to operate the equipment.

Nikon Inc.,
1300 Walt Whitman Road, Melville, New York
11747-3064, U.S.A.
Tel.: 631-547-4200

✔ **Notice for Customers in Canada**

CAUTION

This Class B digital apparatus complies with Canadian ICES-003.

ATTENTION

Cet appareil numérique de la classe B est conforme à la norme NMB-003 du Canada.

Thank you for your purchase of an MB-D11 multi-power battery pack for use with all Nikon single-lens reflex digital cameras that list the MB-D11 as a compatible accessory in the camera manual. The MB-D11 takes one EN-EL15 rechargeable battery or six AA batteries (alkaline, Ni-MH, or lithium) and includes an alternate shutter-release button, **AE-L/AF-L** button, multi selector, and main and sub-command dials for taking pictures in "tall" (portrait) orientation. Camera menu options allow the user to choose whether the camera battery or the batteries in the MB-D11 are used first; see the camera manual for details.

The MB-D11 and Accessories

The MB-D11 and Supplied Accessories

Confirm that the following items are supplied with the MB-D11 (batteries are sold separately).

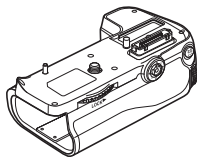

MB-D11

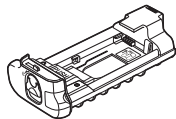

MS-D11EN holder
for EN-EL15 batteries

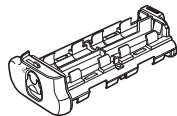

MS-D11 holder for
AA batteries

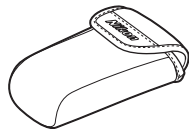

Holder case

The MS-D11EN is inserted in the MB-D11 at shipment. See "Inserting Batteries" for information on removing the battery holder.



Contact cap

- User's manual (this manual)
- Warranty

Using the Optional EH-5a AC Adapter and EP-5B Power Connector

The optional EH-5a AC adapter and EP-5B power connector provide a reliable power source when the camera is used for extended periods. To use an AC adapter with the MB-D11, insert the EP-5B into the MS-D11EN battery holder as described on page 7 and then connect the EH-5a as described in the documentation provided with the EP-5B.

Parts of the MB-D11 (Figure A)

- ① Contact cap
- ② Holder for camera contact cover
- ③ Power/signal contacts
- ④ **AE-L/AF-L** button
- ⑤ Main command dial
- ⑥ Multi selector
- ⑦ Attachment wheel
- ⑧ Holder power connector cover
- ⑨ Battery-chamber cover
- ⑩ Battery chamber
- ⑪ Battery-chamber latch
- ⑫ Mounting screw
- ⑬ Shutter-release button
- ⑭ Control lock
- ⑮ Sub-command dial
- ⑯ Tripod socket
- ⑰ MS-D11EN holder for EN-EL15 batteries
- ⑱ Power terminals
- ⑲ Power terminals (MS-D11EN battery holder)
- ⑳ MS-D11 holder for AA batteries
- ㉑ Power terminals (MS-D11 battery holder)

The MB-D11 Shutter Release Button, Multi Selector, Command Dials, and AE-L/AF-L Button

The MB-D11 is equipped with a shutter-release button (Figure A-⑬), multi selector (Figure A-⑥), main command dial (Figure A-⑤), sub-command dial (Figure A-⑮), and **AE-L/AF-L** button (Figure A-④) for use when taking photographs in vertical (“tall,” or portrait) orientation. These controls perform the same functions as the corresponding controls on the camera and are affected by changes to options in the Custom Settings menu (Group f) that affect these camera controls. See the camera manual for more information.

The MB-D11 Control Lock

The control lock (Figure A-⑭) locks the controls on the MB-D11 to prevent unintended use. Before using these controls to take photographs in vertical (portrait) orientation, release the lock as shown at right.

The control lock is not a power switch. Use the camera power switch to turn the camera on and off.

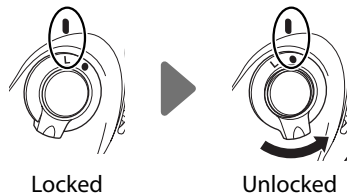

Using the Battery Pack

Attaching the Battery Pack

Before attaching the battery pack, be sure that the camera is off and that the MB-D11 control lock (Figure A-⑭) is in the **L** position (the illustrations show the D7000).

- 1 Remove the contact cap (Figure A-①) from the battery pack.
- 2 The contacts for the MB-D11 are in the base of the camera, where they are protected by a contact cover. Remove the contact cover as shown in Figure B-① and place it in the contact cover holder on the MB-D11 (Figure B-②).
- 3 Position the MB-D11, keeping the MB-D11 mounting screw (Figure C-②) aligned with the camera tripod socket (Figure C-①) and tighten the attachment wheel by rotating it in the direction shown by the **LOCK** arrow (Figure D). There is no need to remove the battery from the camera before connecting the MB-D11. At default settings, the battery inserted in the camera will be used only after the battery in the MB-D11 is exhausted. The **Battery order** option in the camera Custom Settings menu (Group d) can be used to change the order in which the batteries are used. See the camera manual for details.

Be sure to place the camera contact cover in the contact cover holder and to keep the MB-D11 contact cap in a safe place to prevent loss.

A PB-6D and PK-13 auto-extension ring are required when using PB-6 bellows with the MB-D11.

Removing the Battery Pack

To remove the MB-D11, turn the camera off and set the control lock on the MB-D11 to **L**, then loosen the attachment wheel and remove the MB-D11. Be sure to replace the contact cover on the camera and the contact cap on the MB-D11 when the battery pack is not in use.

Inserting Batteries

The MB-D11 can be used with one EN-EL15 rechargeable Li-ion battery, or with six AA batteries.

Before inserting batteries, be sure that the camera is off and that the MB-D11 control lock is in the **L** position.

- 1 Turn the MB-D11 battery-chamber latch to  and remove the battery holder (Figure E).
- 2 Ready the batteries as described below.

EN-EL15: Matching the indentations on the battery to the projections on the MS-D11EN holder, insert the battery with the arrow () on the battery toward the battery holder power terminals (Figure F-①). Press the battery lightly downward and slide it in the direction of the arrow until the power terminals click into place (Figure F-②).

AA batteries: Place six AA batteries in the MS-D11 battery holder as shown in Figure G, making sure that the batteries are in the correct orientation.

- 3 Insert the battery holder in the MB-D11 and latch the battery-chamber cover (Figure H). Make sure the holder is fully inserted before turning the latch.
- 4 Turn the camera on and check the battery level in the control panel or viewfinder. If the camera does not turn on, check that the battery is correctly inserted.







The EP-5B Power Connector

When using the EP-5B power connector, insert it into the MS-D11EN holder with the arrow () on the connector toward the battery power terminals. Press the connector lightly downward and slide it in the direction of the arrow until the power terminals click into place (Figure I-①). Open the holder power connector cover and pass the EP-5B power cable through the opening (Figure I-②).





Battery Level



The camera displays battery level as follows:

EN-EL15

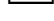
Control panel	View-finder	Description
	—	Battery fully charged.
	—	Battery partially discharged.
		
		Low battery. Ready fully-charged spare battery or charge battery.
 (blinks)	 (blinks)	Battery exhausted. Charge or exchange battery.



AA Batteries

Control panel	View-finder	Description
	—	Charge remaining.
		Low batteries. Ready spare batteries.
 (blinks)	 (blinks)	Batteries exhausted. Shutter release disabled.

An option in Group d of the camera Custom Settings menu can be used to change the order in which the batteries are used. When the camera is drawing power from the MB-D11, a  icon is displayed in the control panel. If the  icon blinks, the battery-chamber cover is not locked. Close and latch the battery-chamber cover.

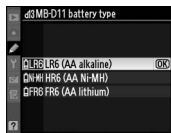
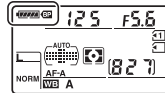
To ensure that the camera shows the correct battery level when AA batteries are used, choose the appropriate option for **MB-D11 battery type** in the camera Custom Settings menu (Group d). If the correct option is not selected, the camera may fail to function as expected.



Option	Battery type
 LR6 (AA alkaline)	AA alkaline (LR6)
 HR6 (AA Ni-MH)	AA Ni-MH (HR6)
 FR6 (AA lithium)	AA Lithium (FR6)

Remove the batteries when the MB-D11 is not in use.

Battery Info

Battery information can be viewed from the camera setup menu (the camera battery is listed on the left, the MB-D11 on the right). Only the battery level icon is shown when AA batteries are used. See the camera manual for details.

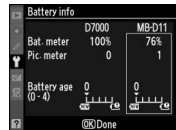

Note: The illustrations on this page are from the D7000.

Removing Batteries

Be careful not to drop batteries or the holder.

- 1 Turn the MB-D11 battery-chamber latch to  and remove the battery holder (Figure E).
- 2 Remove the battery or batteries from the holder.

EN-EL15

While pressing the holder **PUSH** button, slide the battery toward the button. The battery can then be removed as shown.

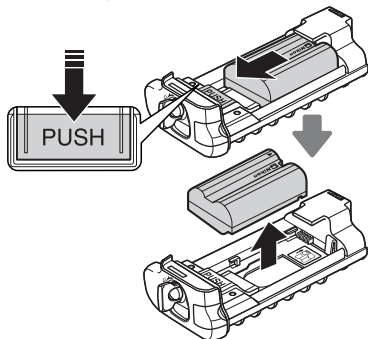

The procedure for removing the EP-5B power connector is the same as that for the EN-EL15.

AA Batteries

Remove the batteries as shown. Be careful not to drop the batteries when removing them from the holder.

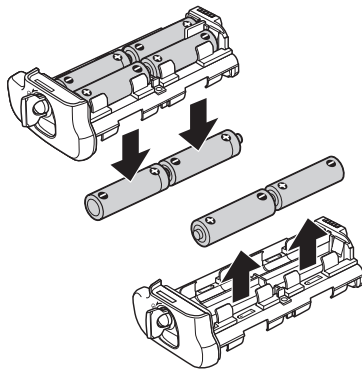

Specifications

En

Power source	One EN-EL15 rechargeable Li-ion battery, six LR6 alkaline, HR6 Ni-MH, or FR6 lithium AA batteries, or EH-5a AC adapter (requires EP-5B power connector)
Operating temperature	0 – 40 °C (32 – 104 °F)
Dimensions (W × H × D)	Approx. 133 × 50 × 73 mm/5.2 × 2.0 × 2.9 in.
Weight	Approx. 245 g (8.6 oz) with MS-D11EN Approx. 335 g (11.8 oz) with MS-D11EN and optional EN-EL 15 battery Approx. 275 g (9.7 oz) with MS-D11EN and optional EP-5B power connector Approx. 245 g (8.6 oz) with MS-D11 Approx. 390 g (13.6 oz) with MS-D11 and six AA batteries (available separately from third-party suppliers)

Specifications and design are subject to change without notice.

EN-EL15 Battery

The performance of EN-EL15 battery drops at temperatures below about 10 °C (50 °F). Be sure the battery is fully charged and keep a warm spare battery on hand ready to exchange as necessary. Cold batteries will recover some of their charge when warmed.

AA Batteries

Due to their limited capacity, AA LR6 alkaline batteries should be used only when no other alternative is available.

The capacity of AA batteries varies with make and storage conditions and may in some instances be extremely low; in some cases, AA batteries may cease to function before their expiry date. Note that the capacity of AA batteries may drop at temperatures below 20 °C (68 °F). Use is not recommended at low temperatures.

Nikon



NIKON CORPORATION

Printed in Japan

© 2010 Nikon Corporation

SB5104(W0)
6MFC01W0-04